

# ALL INDIA INSTITUTE OF MEDICAL SCIENCES BHUBANESWAR



परा यक्ष्मं सुवापि ते

**KNOW YOUR  
CENTRAL LIBRARY**

TERRACE  
LVL +10500

NEWSPAPER  
READING  
AREA

BOOK  
&  
PERIODICAL  
DISPLAY  
AREA

E-LIBRARY

Gents Toilet

Drinking  
Water

Ladies  
Toilet

Drinking  
Water

# AIIMS BHUBANESHWAR CENTRAL LIBRARY FLOOR MAP

READING  
AREA

FACULTY  
READING  
AREA

LIBRARIAN  
ROOM

TERRACE  
BELOW  
AT  
+6330

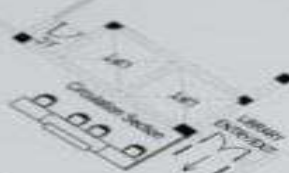

You Are  
Here

# AGENDA

- **Introduction**
- **Library Rules & Regulations**
- **Library Resources**
- **Library Service And Facilities**
- **How To Get Library Resources**
- **Future Perspective**
- **Contact Us**

# INTRODUCTION

Central library occupies a place of pride in AIIMS, Bhubaneswar is an essential component of the institute's outstanding research and education mission. It is a most lively place on the campus providing a safe, comfortable and friendly environment that enables learning and advancement of knowledge, and promotes discovery with wi-fi facility. The main aim of the libraries is to serve the required information to the library users within a short span of time.

# WORKING HOURS OF LIBRARY

- **MONDAY TO FRIDAY : 9.00 A.M. – 9.00 P.M.**
- **SATURDAY : 9.00 A.M. – 5.00 P.M.**
- **SUNDAY & HOLIDAYS CLOSED**
- **READING ROOM : (24 X 7)**

# LIBRARY RULES & REGULATIONS

- **A Register is available at entrance of the Library. Users are requested to make their entry while entering and departing from the library.**



# LIBRARY RULES & REGULATIONS

- **Identity Card/ Library Card is mandatory while visiting or using the library.**
- **Readers shall not write upon, damage, or make any mark on books, periodicals or other material belonging to the library.**
- **Smoking, eating and drinking beverages is prohibited inside the library reading rooms and E-Library.**

# LIBRARY RULES & REGULATIONS

- **Late fee of Rs 5/day/book would be charged from the borrowers who retain book(s) beyond the due date.**
- **Book may be renewed if the same is not in demand or reserve by other user. It will be done only 2 times.**



# LIBRARY RESOURCES

- **11000+ books in Medical, Nursing, Dental and Paramedical, Administration, Dictionary, NRHM & WHO, Odia and Hindi Languages.**
- **21nos. Treatment Protocols.**
- **39 nos. Bound Volumes are available.**
- **491 nos. of CDs & DVDs are available.**
- **243 nos. MD, MS, DM, MCh, BSc., MSc. Thesis.**

# LIBRARY RESOURCES

- **National & International journals are available for reference in the library.**
- **Magazines are available in Periodical Section.**
- **Annual Report, Insight, Arogya Sudha(Hindi) and others AIIMS Publications are available.**



Central Library, AIIMS, Bhubaneswar

# LIBRARY RESOURCES

**13 Hindi, English, Odia language Newspaper are available for reading purpose.**



# ON-LINE RESOURCES AT A GLANCE

## E-Databases

**UpToDate**

**Clinical Key**

**BMJ Best Practice**

**OVID (LWW Total Collection), NEJM & JAMA Series & Medknow Journals**

**CINHAL**

**Clinical Key For Nursing**

**ERMED Consortium**

**Access Medicine**

**Grammarly (Online Grammar Checker)**

**Dspace (Institutional Repository)**

**Total 8 Databases , 1 Writing Tool & 1 Digital Repository**

# ON-LINE RESOURCES AT A GLANCE

<b>E-JOURNALS</b>	<b>NO.</b>
<b>Individual Purchase</b>	<b>49</b>
<b>Clinical Key</b>	<b>706+</b>
<b>BMJ</b>	<b>21</b>
<b>OVID (LWW Publication)</b>	<b>290+</b>
<b>Medknow (Free with LWW)</b>	<b>452</b>
<b>NEJM &amp; JAMA Series</b>	<b>11</b>
<b>CINHAL</b>	<b>1315+</b>
<b>Clinical Key Nursing</b>	<b>69+</b>
<b>ERMED (Consortium)</b>	<b>242</b>
<b>TOTAL</b>	<b>3155+</b>

# ON-LINE RESOURCES AT A GLANCE

<b>E-BOOKS</b>	<b>NO.</b>
<b>Clinical Key</b>	<b>997+</b>
<b>Access Medicine</b>	<b>220+</b>
<b>Clinical Key Nursing</b>	<b>125+</b>
<b>Total</b>	<b>1342+</b>

10 Thousands+  
Books



Eight (8)  
Databases



Access to  
3185+  
e-journal titles



C  
E  
N  
T  
R  
A  
L  
L  
I  
B  
R  
A  
R  
Y

322

ebook  
downloads

242 ERMED  
E-Journals



1342+  
ebooks

491  
CD/DVDs

7000+  
ejournal  
downloads



10,000  
library  
visits

1300 Nos.  
Instisutional  
Repository  
DSPACE



243 Nos  
MD/ MS/  
MCh/DM and  
BSc. & MSc  
Nursing  
Thesis



A  
I  
I  
M  
S

39  
Bound  
Volume



106  
General  
Reading  
Area

39  
FACULTY  
READING  
AREA

SITTING ARRANGEMENTS

12  
Main  
Library  
+  
20  
Newspaper  
Area

56  
E-LIBRARY  
+  
12  
LAPTOP  
POINTS

# GENERAL READING ROOM



**OPENS 24X7**



# FACULTY READING ROOM



**OPENS 24X7**

# E-LIBRARY



**OPENS DURING LIBRARY WORKING HOURS**

# BOOK BORROWING FACILITIES

<b>Users</b>	<b>No. of Books</b>	<b>No. of Days</b>
Faculty (Med, AYUSH & Nursing)	2	30 days
JR/SR(Academic)	2	30 days
MSc. Nursing	2	30 days
JR/SR(Non-Academic)	2	15 days
MBBS	2	15 days
BSc. Nursing	2	15 days
BSc. Paramedical	2	15 days
Hospital Staff/ Admin. Staff	2	15 days
Nursing Officer	2	15 days

# WEB PAGE OF Library Catalogue

koha

Cart

Lists

Log in to your account

Weekly New Additions



## CENTRAL LIBRARY Online Public Access Catalogue

अखिल भारतीय आयुर्विज्ञान संस्थान, भुवनेश्वर  
ଅଖିଳ ଭାରତୀୟ ଆୟୁର୍ବିଜ୍ଞାନ ପ୍ରତିଷ୍ଠାନ, ଭୁବନେଶ୍ୱର

### All India Institute of Medical Sciences, Bhubaneswar

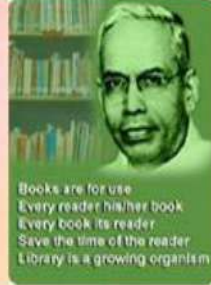

Search

URL in our AIIMS Network <http://10.200.10.150:8001/cgi-bin/koha/opac-main.pl>

Home

Our Institute

About

Services

Resources

Floor Map

Downloads

Activities

### Quote of the day

Let me assert my firm belief that the only thing we have to fear is fear itself. ~ Franklin D. Roosevelt

New Book Arrivals

Book jackets

### Library Hours

(a) Mon - Fri	9:00 AM - 9:00 PM
(b) Saturday	9:00 AM - 4:30 PM
(c) Sunday	9:15 AM - 5:15 PM
(d) Reading Room	6:00 AM - Midnight (Everyday)

### Circulation Timings

(a) Mon - Fri	9.00 AM - 9:00 PM
(b) Saturday	9.00 AM - 4:30 PM
(c) Sunday	9:30 AM - 5:15 PM

# LIBRARY WEBSITE AND REMOTE ACCESS

For Access in AIIMS Network(NKN)

<https://aiimsbhubaneswar.nic.in/library/>

## Remote Access

Access any where any time outside AIIMS network.

<https://aiimsbhubaneswar.knimbus.com/user#/home>

# LIBRARY WEB PAGE

→ ↻ 🔒 <https://aiimsbhubaneswar.nic.in/library/>



केन्द्रीय पुस्तकालय, एम्स भुवनेश्वर  
Central Library, AIIMS Bhubaneswar



- ABOUT LIBRARY
- MEMBERSHIP
- SERVICES
- LIBRARY COMMITTEE
- WEB CATALOGUE
- PERIODICALS
- ONLINE JOURNALS ▾
- KNIMBUS
- DIGITAL REPOSITORY (DSpace)
- WEB RESOURCES
- CONTACT US



## About Library

Central Library started functioning since 3rd October 2012 under the Chairmanship of Dr. Pranati Nanda, Additional Prof. Department of Physiology whose painstaking effort saw the library grow by leaps and bounds. Presently, the library is being headed by Prof. (Dr.) A. K. Praharaj, HOD, Department of Microbiology under whose leadership the

## News & Notification

Access online resources anywhere and anytime  
[Access Medicine](#)  
[Covid-19 updated information \(Ebsco\)](#)

# LINK TO ALL ONLINE RESOURCES

Central Library,  
All India Institute of Medical Sciences (AIIMS), Bhubaneswar  
**Online Journals & Databases (alphabetical list)**

(Updated on 1<sup>st</sup> April 2022)

**A B C D E F G H I J K L M N O P**  
**Q R S T U V W X Y Z**

**ClinicalKey:** A search platform for 670+ journals of Elsevier including reputed series like Advances, Best practices & research, Clinical, Current opinion, Seminars, Trends, Clinics in North America, Lancet, etc., electronic (e)books, dedicated to medical sciences which simultaneously searches PubMed. Registration is free in institute network which will help in downloading relevant information. Mobile app facility is there.

**BMJ Journals** is a collection of more than 38 medical and allied science titles. - Browse by journal list.

**LWW TOTAL ACCESS COLLECTION (OVID) :** The LWW Total Access Collection is an expansive collection of all LWW journals available on the Ovid platform and that cater to your intensive medical information needs - when just a few core journals are not enough.

**Access Medicine:** McGraw-Hill medical publishing eBooks, and other clinical resources.

**CINAHL Complete:** Reference database focused to Nursing literature includes journals, ebooks etc.

**UPTODATE :** Clinical decision support tool, registration will facilitate to access more features also to access in mobile or laptop. Registration for library users is free in institute network.

**All MedKnow journals:** 452 titles which are published by MedKnow in collaboration with Wolters Kluwer includes reputed medical society journals.

**ClinicalkeyNursing :** Clinical key for Nursing, around 65 Elsevier journals, 90+ ebooks, drug monographs, Mosby's Evidence-Based Nursing Monographs etc. Mobile app facility is there.

**ERMED:** Electronic Resources in Health Sciences (NML-ERMED-India) Consortium, Managed by National Medical Library, New Delhi. It is an initiative of Directorate General of Health Services (Dte.GHS), Ministry of Health & Family Welfare (MOH & FW), Government of India. We are also a member of this consortium.

Username and password is not required whenever users are using AIIMS Bhubaneswar internet network (NKN) to access journals/databases, however, when users want to use them in their own digital gadgets (mobile, laptop) having different network, they can do so using **KNIMBUS-Elibrary:** username and password will be provided by the Library to the individual users. Please download **mlibrary** mobile app for mobile access.

**Library Catalogue for books (intranet only)**

**Grammarly :** writing tool (please create an account/contact the library)

Sl. No	Journal Title	ISSN	Years Covered	Publisher
1	A and A Case Reports	2325-7237	2013 to 2017	Wolters Kluwer
2	A and A Practice	2575-3126	2018 to Present	Wolters Kluwer
3	AACE Clinical Case Reports	2376-0605	2015 to Present	Elsevier
4	AACN Advanced Critical Care	1559-7768	2007 to Present	Elsevier
5	Academic Emergency Medicine	1553-2712	Present	Wiley
6	Academic Medicine	1040-2446	2000 to Present	Wolters Kluwer
7	Academic Pediatrics	1876-2859	2009 to Present	Elsevier
8	Academic Physician and Scientist	1093-1139	2001 to 2009	Wolters Kluwer
9	Academic Radiology	1076-6332	2007 to Present	Elsevier
10	ACG Case Reports Journal	2326-3253	2013 to Present	Wolters Kluwer
11	ACSM'S Health and Fitness Journal	1091-5397	2004 to Present	Wolters Kluwer
12	Acta Medica International	2349-0896	to Present	Medknow
13	Acta Neuropsychiatrica	1601-5215	2016 to Present	CUP
14	Acta Paediatrica	1651-2227	Present	Wiley
15	Actas Dermo-Sifilográficas	0001-7310	2008 to Present	Elsevier
16	Acupuncture and Herbal Medicine	2765-8619	2021 to Present	Wolters Kluwer
17	Addictive Behaviors Reports	2352-8532	2015 to Present	Elsevier
18	Addictive Behaviors	0306-4603	2007 to Present	Elsevier
19	Addictive Disorders and Their Treatment	1531-5754	2002 to 2021	Wolters Kluwer
20	Advanced Arab Academy of Audio-Vestibology Journal	2314-8675	2014 to 2017	Medknow
21	Advanced Biomedical Research	2277-9175	2012 to Present	Medknow
22	Advanced Emergency Nursing Journal	1931-4485	2006 to Present	Wolters Kluwer
23	Advances in Anatomic Pathology	1072-4109	2001 to Present	Wolters Kluwer
24	Advances in Anesthesia	0737-6146	2007 to Present	Elsevier
25	Advances in Biomedical and Health Sciences	2773-1553	to Present	Medknow
26	Advances in Cancer Biology - Metastasis	2667-3940	2021 to Present	Elsevier
27	Advances in Chronic Kidney Disease	1548-5595	2007 to Present	Elsevier
28	Advances in Clinical Radiology	2589-8701	2019 to Present	Elsevier
29	Advances in Cosmetic Surgery	2542-4327	2018 to Present	Elsevier
30	Advances in Family Practice Nursing	2589-420X	2019 to Present	Elsevier
31	Advances in Human Biology	2348-4691	2013 to Present	Medknow
32	Advances in Integrative Medicine	2212-9588	2014 to Present	Elsevier
33	Advances in Molecular Pathology	2589-4080	2018 to Present	Elsevier
34	Advances in Neonatal Care	1536-0903	2001 to Present	Wolters Kluwer

# WEB INTERFACE OF UPTODATE

UpToDate®

All India Institute of Medical Sciences Bhubaneswar ▾

[Contents](#) ▾ [Calculators](#) [Drug Interactions](#) [UpToDate Pathways](#)

[Register](#) [Log In](#)

**You have to register through your e-mail id in**

**AIIMS network**

Search UpToDate

**You can access through UpToDate App in your  
mobile, Tabs, etc.**



# WEB INTERFACE OF CLINICALKEY

ClinicalKey®

English CME Store Login Register ? ☰

**You have to register through your e-mail id in AIIMS network**

Search for conditions, procedures, drugs, and more

All Types  

Browse

[Books](#) [Journals](#) [Drug Monographs](#) [Guidelines](#) [Patient Education](#) [First Consult/Clinical Overviews](#) [...](#)

# WEB INTERFACE OF BMJ BEST PRACTICE

You have to register through your e-mail id in

Access provided by: AIIMS Bhubaneswar

## AIIMS network

[Log in](#) [Create account](#) [Help](#) ▾

Create your FREE personal account in one step ✕

Email

Password

Repeat password

By registering with BMJ Best Practice you are agreeing to BMJ's [terms and conditions](#) and its [privacy policy](#).

Tick to receive information and special offers about BMJ's products and services. BMJ will mainly contact you by email but occasionally by post, telephone, or SMS.

**CREATE ACCOUNT**

Already have a personal account? [LOG IN](#).



With a personal account, you can:

- Use the highly rated BMJ Best Practice app, even offline
- Get CME/CPD certificates for time spent on BMJ Best Practice
- Access BMJ Best Practice anywhere

Do not show me this again [CLOSE](#)

# WEB INTERFACE OF OVID

Ovid®

[My Account](#) [My PayPerView](#)



 Wolters Kluwer

[Help](#) [Feedback](#) [Logout](#)

[Search](#)

[Journals](#)

[Books](#)

[Multimedia](#)

[My Workspace](#)

[What's New](#)

**You have to browse through AIIMS network**

# WEB INTERFACE OF CINAHL COMPLETE (CUMULATIVE INDEX OF NURSING AND ALLIED HEALTH)

web.a.ebscohost.com/ehost/search/basic?vid=0&sid=9676a76b-2534-4502-b0c4-d9484d94f7d:%40sessionmgr4006

New Search CINAHL Headings Publications Images More Sign In Folder Preferences Languages Help Exit

AIIMS BHUBANESWAR

EBSCOhost

Searching: CINAHL Complete, Show all | Choose Databases

Enter any words to find books, journals and more Search

Search Options Basic Search Advanced Search Search History

Mobile Site iPhone and Android apps EBSCO Support Site Privacy Policy Terms of Use Copyright

© 2018 EBSCO Industries, Inc. All rights reserved.

Steps Recorder - Recording Now

Pause Record Stop Record Add Comment

**You have to browse through AIIMS network**

# WEB INTERFACE OF CLINICAL KEY NURSING



ClinicalKey<sup>®</sup> for Nursing

CE Login Register ⓘ ☰

## ClinicalKey - Lead with Answers

Search for conditions, treatments, drugs, books, journals and more

All Types ▾  Search

**You have to register through your e-mail id in AIIMS network**

## Browse clinical content

Diagnose conditions and validate decisions

<p>Clinical Overviews &gt;</p> <p>Comprehensive topic summaries for your clinical questions</p>	<p>Clinical Skills &gt;</p> <p>Skills and procedures for quick review and learning</p>	<p>Drug Monographs &gt;</p> <p>Drug and dosing information to guide treatment decisions</p>	<p>Mosby's Evidence-Based Nursing Monographs &gt;</p> <p>Research-driven answers to your clinical questions</p>
<p>Patient Education &gt;</p>	<p>Guidelines &gt;</p>	<p>Calculators &gt;</p>	<p>Labs &gt;</p>

# WEB INTERFACE OF ERMED

NATIONAL MEDICAL LIBRARY

[Home](#) [Members](#) [Journals](#) [Publishers](#) [Agents](#) [About NML](#) [e-Training](#) [Acknowledgement](#) [Contact](#)



## ERMED CONSORTIUM

Electronic Resources in Medicine (ERMED-India) Consortium, Managed by National Medical Library, New Delhi, India

An initiative of Directorate General of Health Services (DGHS), Ministry of Health & Family Welfare (MOH & FW), Government of India

# You have to browse through AIIMS network

## ABOUT NATIONAL MEDICAL LIBRARY

DOWNLOAD SUBJECT-WISE LIST  

PUBLISHER WISE LIST   

### A. BMJ PUBLISHING GROUP

1		ANNALS OF THE RHEUMATIC DISEASES
2		ARCHIVES OF DISEASE IN CHILDHOOD
3		BRITISH JOURNAL OF OPHTHALMOLOGY

ALPHABATICAL LIST   

### LIST OF JOURNALS

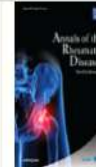
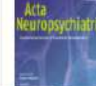
1		ANNALS OF THE RHEUMATIC DISEASES
2		ACADEMIC MEDICINE
3		ACTA NEUROPSYCHIATRICA

# WEB INTERFACE OF ACCESS MEDICINE

McGraw Hill Medical

Support

Subscribe

English

Sign In

All India Institute of Medical Sciences, Bhubaneswar

Access Provided by: All India Institute of Medical Sciences, Bhubaneswar



Books Quick Reference Infographics Drugs Multimedia Cases Study Tools Patient Ed Hospital Corner

AccessMedicine

Search AccessMedicine



About

Search

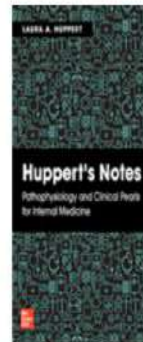
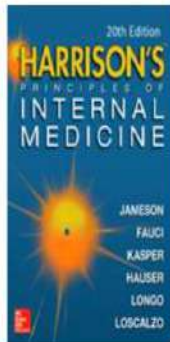

Browse Books by Topic

Get Alerts

Harrison's Channel



Infographic Guide to Medicine



BioDigital Anatomy Modules



# WEB INTERFACE OF GRAMMARLY



Log in

## Great Writing, Simplified

Compose bold, clear, mistake-free writing with Grammarly's AI-powered writing assistant.

Add to Chrome It's free

★★★★★ 40,000+ Chrome store reviews

30 million people use Grammarly to improve their writing



Dear User

Here's where we stand on the various tracks for this project: audience research (90% complete), final budget secured (100% complete), design exploration (40% complete), prototype build (10% complete), legal review (0% complete).



# WEB INTERFACE OF REMOTE ACCESS FACILITY



All India Institute of Medical Sciences, Bhubaneswar

eCatalog ▾ Explore ▾ Research+ Contact us

Sign In

Title ▾ Search for title, author etc

Please avail Cash Less Transaction Facility at AIMS, Bhubaneswar

Source [\(View All\)](#)



BioMed



British Medical Journal (BMJ)



Cambridge University Press



EBSCO



Karger



Lippincott Williams and Wilkins - OVID



McGraw Hill Education



Oxford University Press (OUP)



Pubmed



Springer



Wiley Online Library

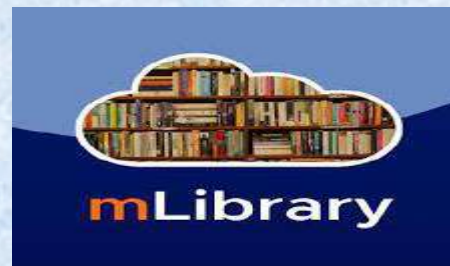

# CONTACT US



**[centrallibrary@aiimsbhubaneswar.edu.in](mailto:centrallibrary@aiimsbhubaneswar.edu.in)**



**0674-2476900**



**Central Library, AIIMS, Sijua,**

**Dumuduma, Bhubaneswar, Odisha, 751019**

Thank  
you!